

# SLE6 • SLE10

Dust Proof



## Miniature Power Rocker Switches

C-US UL CSA VDE SEMKO

RoHS Compliant

### Features

1. C-US UL, CSA, VDE and SEMKO approved products
2. Snap-in panel mounting
3. Compact size is suited for space-saving design.
4. Best suited for power supply of equipment.
5. Dust-proof type
6. Breaking distance is 3 mm or over.

### Specifications

Rating	SLE6	Max.	6A 125VAC · 4A 250AC (Resistive load.)
		Min.	10mA 5VAC/DC (Resistive load.)
	SLE10	Max.	10A 125VAC · 5A 250VAC (Resistive load.)
		Min.	10mA 5VAC/DC (Resistive load.)
Initial contact resistance		20mΩ max. (1A 2~4V DC)	
Dielectric strength		1,500VAC 1 minute (Between terminals)	
Insulation resistance		100MΩ min. (Between terminals) (500VDC)	
Electrical life		10,000 cycles	
Operating force		2.45~12.7N	
Operating temperature range		-25~+85°C	
Storage temperature range		-40~+85°C	

### Part Numbering

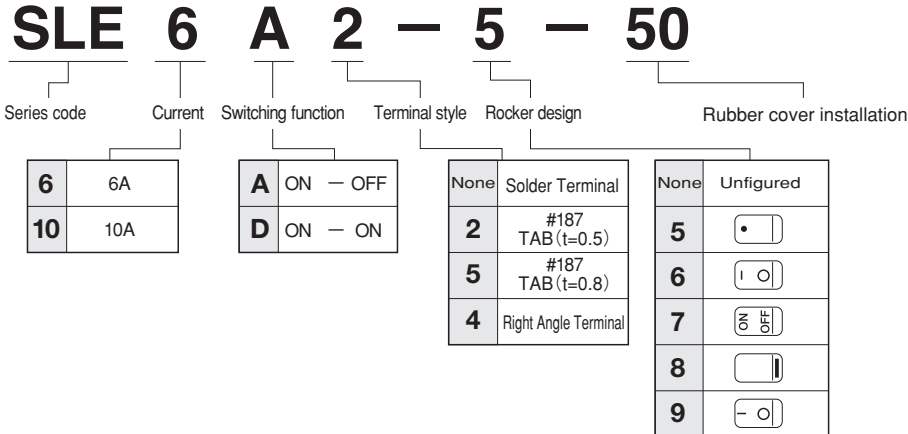

### Approvals

UL File No.E43275  
 CSA File No.LR38341  
 VDE License No.120752  
 SEMKO File No.1312452

### Terminal Styles

Terminal styles	Solder Terminal	TAB#187		Right Angle Terminal
styles	None	2	5	4
Dimensions	 t=0.8	 t=0.5	 t=0.8	 t=0.8

### Marking Color

Frame color-Rocker color	Marking color
Black	White

The black color is standard for the frame and the rocker.  
 The gray and the ivory colors are also available as custom-made items.

## SLE6 • SLE10

SLE6A  
SLE6D  
SLE10A  
SLE10D

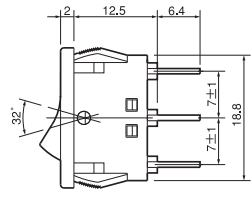
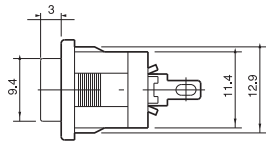
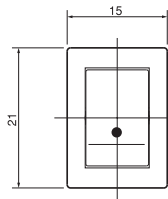

Part No. & rating marking

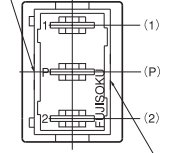

Switching function	Viewed from part No. & rating marking side	
Part No.		
SLE6A-■ SLE10A-■	ON	OFF
Connecting terminals	P-1	-
SLE6D-■ SLE10D-■	ON	ON
Connecting terminals	P-1	P-2

■ : Show the rocker design number.

Solder Terminal

The switching function Type "A" is without terminal number (2).

SLE6A2  
SLE6D2  
SLE10A2  
SLE10D2

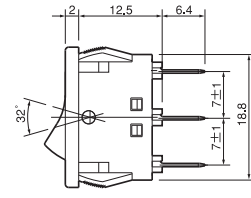
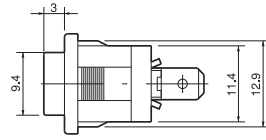
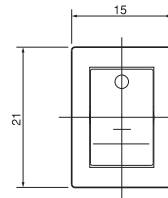

Part No. & rating marking

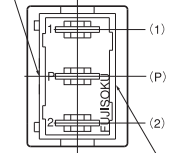

Switching function	Viewed from part No. & rating marking side	
Part No.		
SLE6A2-■ SLE10A2-■	ON	OFF
Connecting terminals	P-1	-
SLE6D2-■ SLE10D2-■	ON	ON
Connecting terminals	P-1	P-2

■ : Show the rocker design number.

TAB # 187

The switching function Type "A" is without terminal number (2).

SLE6A4  
SLE6D4  
SLE10A4  
SLE10D4

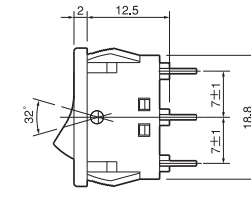
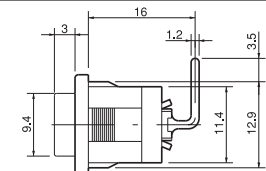
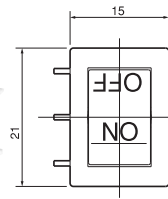
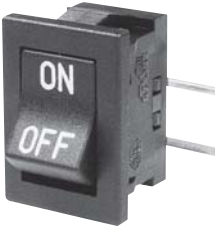

Part No. & rating marking

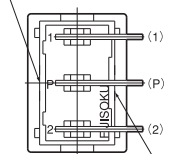

Switching function	Viewed from part No. & rating marking side	
Part No.		
SLE6A4-■ SLE10A4-■	ON	OFF
Connecting terminals	P-1	-
SLE6D4-■ SLE10D4-■	ON	ON
Connecting terminals	P-1	P-2

■ : Show the rocker design number.

Right Angle Terminal

The switching function Type "A" is without terminal number (2).

SLE6A-50 SLE6D-50  
SLE6A2-50 SLE6D2-50  
SLE6A4-50 SLE6D4-50  
SLE6A5-50 SLE6D5-50

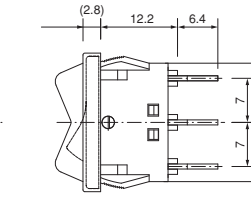
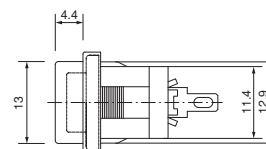
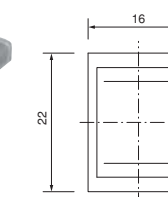

Part No. & rating marking

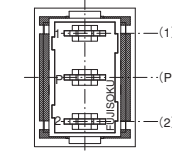

Switching function	Viewed from part No. & rating marking side	
Part No.		
SLE6A-50 SLE6A2-50 SLE6A4-50 SLE6A5-50	ON	OFF
Connecting terminals	P-1	-
SLE6D-50 SLE6D2-50 SLE6D4-50 SLE6D5-50	ON	ON
Connecting terminals	P-1	P-2

Rubber cover installation

The switching function Type "A" is without terminal number (2).

## PC Hole Layouts

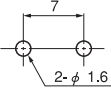
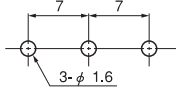
Series	SLE6A4 SLE10A4	SLE6D4 SLE10D4
Dimensions		

## Panel Cut-Out Dimensions

Switches



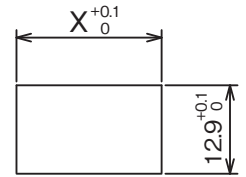

Panel thickness	X
0.75~1.25	19.2
1.25~3.5	19.4

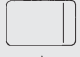

Switch Guard Installation

Panel thickness	X
0.75~2.8	19.4

## Table of Part Numbers

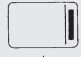
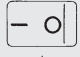
Current	Terminal styles	Switching function	Part No. and rating marking side					
								
6A	Solder Terminal	ON-OFF	SLE6A	SLE6A-5	SLE6A-6	SLE6A-7	★SLE6A-8	☆SLE6A-9
		ON-ON	SLE6D	★SLE6D-5	☆SLE6D-6	▲SLE6D-7	▲SLE6D-8	▲SLE6D-9
	t=0.5 TAB	ON-OFF	SLE6A2	SLE6A2-5	SLE6A2-6	SLE6A2-7	▲SLE6A2-8	☆SLE6A2-9
		ON-ON	SLE6D2	★SLE6D2-5	▲SLE6D2-6	★SLE6D2-7	▲SLE6D2-8	★SLE6D2-9
	t=0.8 TAB	ON-OFF	▲SLE6A5	★SLE6A5-5	★SLE6A5-6	★SLE6A5-7	▲SLE6A5-8	★SLE6A5-9
		ON-ON	▲SLE6D5	▲SLE6D5-5	▲SLE6D5-6	▲SLE6D5-7	▲SLE6D5-8	★SLE6D5-9
	Right Angle Terminal	ON-OFF	▲SLE6A4	★SLE6A4-5	★SLE6A4-6	★SLE6A4-7	▲SLE6A4-8	▲SLE6A4-9
		ON-ON	★SLE6D4	★SLE6D4-5	★SLE6D4-6	★SLE6D4-7	▲SLE6D4-8	▲SLE6D4-9
10A	Solder Terminal	ON-OFF	★SLE10A	★SLE10A-5	★SLE10A-6	☆SLE10A-7	▲SLE10A-8	★SLE10A-9
		ON-ON	★SLE10D	★SLE10D-5	▲SLE10D-6	▲SLE10D-7	▲SLE10D-8	▲SLE10D-9
	t=0.5 TAB#187	ON-OFF	★SLE10A2	SLE10A2-5	SLE10A2-6	★SLE10A2-7	▲SLE10A2-8	★SLE10A2-9
		ON-ON	▲SLE10D2	★SLE10D2-5	★SLE10D2-6	▲SLE10D2-7	▲SLE10D2-8	▲SLE10D2-9
	t=0.8 TAB#187	ON-OFF	▲SLE10A5	☆SLE10A5-5	★SLE10A5-6	▲SLE10A5-7	▲SLE10A5-8	★SLE10A5-9
		ON-ON	★SLE10D5	▲SLE10D5-5	▲SLE10D5-6	★SLE10D5-7	▲SLE10D5-8	▲SLE10D5-9
	Right Angle Terminal	ON-OFF	▲SLE10A4	★SLE10A4-5	▲SLE10A4-6	★SLE10A4-7	▲SLE10A4-8	▲SLE10A4-9
		ON-ON	★SLE10D4	▲SLE10D4-5	▲SLE10D4-6	▲SLE10D4-7	▲SLE10D4-8	▲SLE10D4-9

## Fit on rubber cover

Current	Terminal styles	Switching function	Part No.
6A	Solder Terminal	ON-OFF	★SLE6A-50
		ON-ON	★SLE6D-50
	t-0.5 TAB	ON-OFF	★SLE6A2-50
		ON-ON	★SLE6D2-50
	t-0.8 TAB	ON-OFF	★SLE6A5-50
		ON-ON	★SLE6D5-50
	Right Angle Terminal	ON-OFF	★SLE6A4-50
		ON-ON	★SLE6D4-50

## Handling Precautions

### 1. Soldering Specifications

#### (1) Manual Soldering

Device : Soldering iron  
380°C, Max.; 3 seconds, Max.

※The tab terminals cannot be soldered

### 2. Precautions for panel mounting

Page.....314

## Switch Guard

For details, refer to page 312.