

5 4 3 2 1

Mating face according to : MIL-C-24308 / DIN 41652 / CECC 75301-802

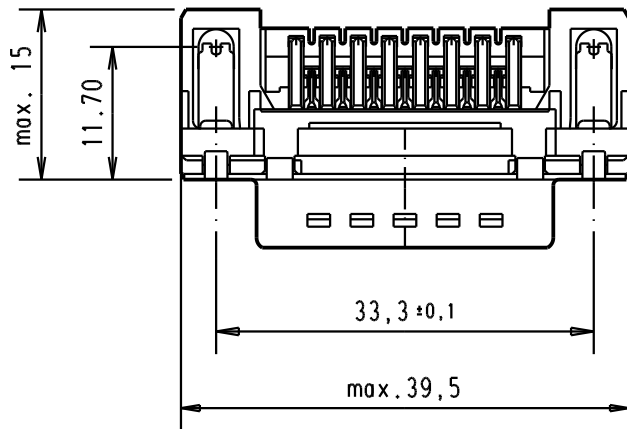

PCB layout hole component side

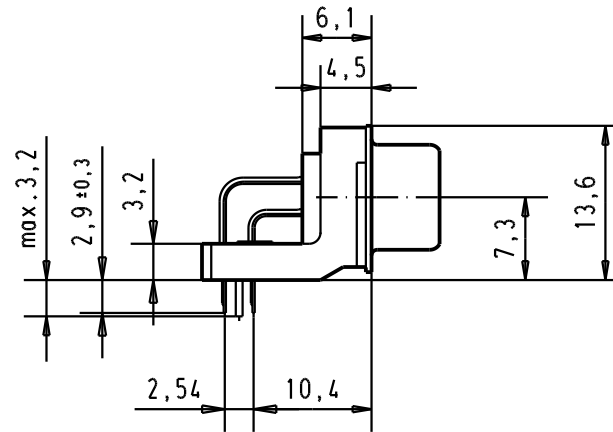
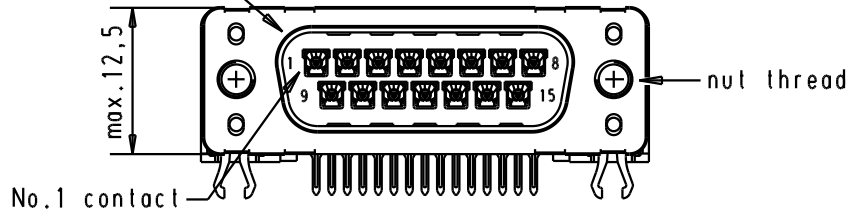
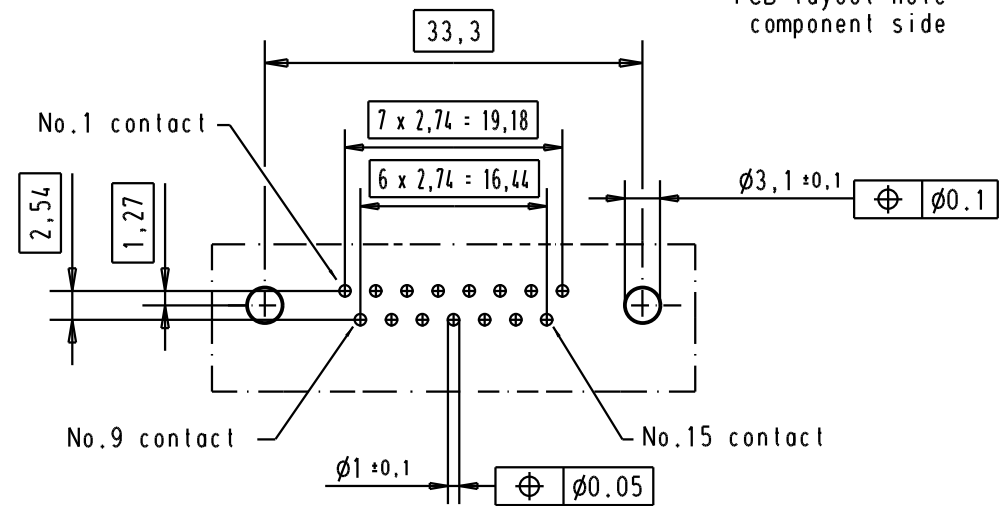

Connector retention and insertion forces on the PCB = 25 / 80 newtons

A	09 65 262 3811	M3	1						 All Dim. in mm Orig. Size DIN A 4	D-Sub, male, standard angle, 15 poles, with solder pin, nut and grounding board lock	Maßstab/ Scale 1.5:1	
	09 65 262 6811	M3	2				Detail.	15/dec/00				ALSPACE
	09 65 262 7811	M3	3	31892	22/04/04	JH	Insp.					
	09 65 262 3812	4-40 UNC	1	31084	04/09/02	YT	Stand.					
	09 65 262 6812	4-40 UNC	2	29689	02/07/01	AA						
	09 65 262 7812	4-40 UNC	3	27960	15/dec/00	ALSPACE	HARTING EUROL F-95972 Paris			TB 0965262x81x Sub.	Blatt/ Page 5	
	Part number	Nut thread	Performance level	Mod.	Dat.	Name						