

HEX CAVITY SIZES: .067 HEX X .080 WIDTH (630046-GA GAGE AVAILABLE)
 .099 HEX X .093 WIDTH (630046-GB GAGE AVAILABLE)
 .325 HEX X .610 WIDTH (630046-GC GAGE AVAILABLE)
 .393 HEX X .110 WIDTH (630046-GD GAGE AVAILABLE)

630046-ENV

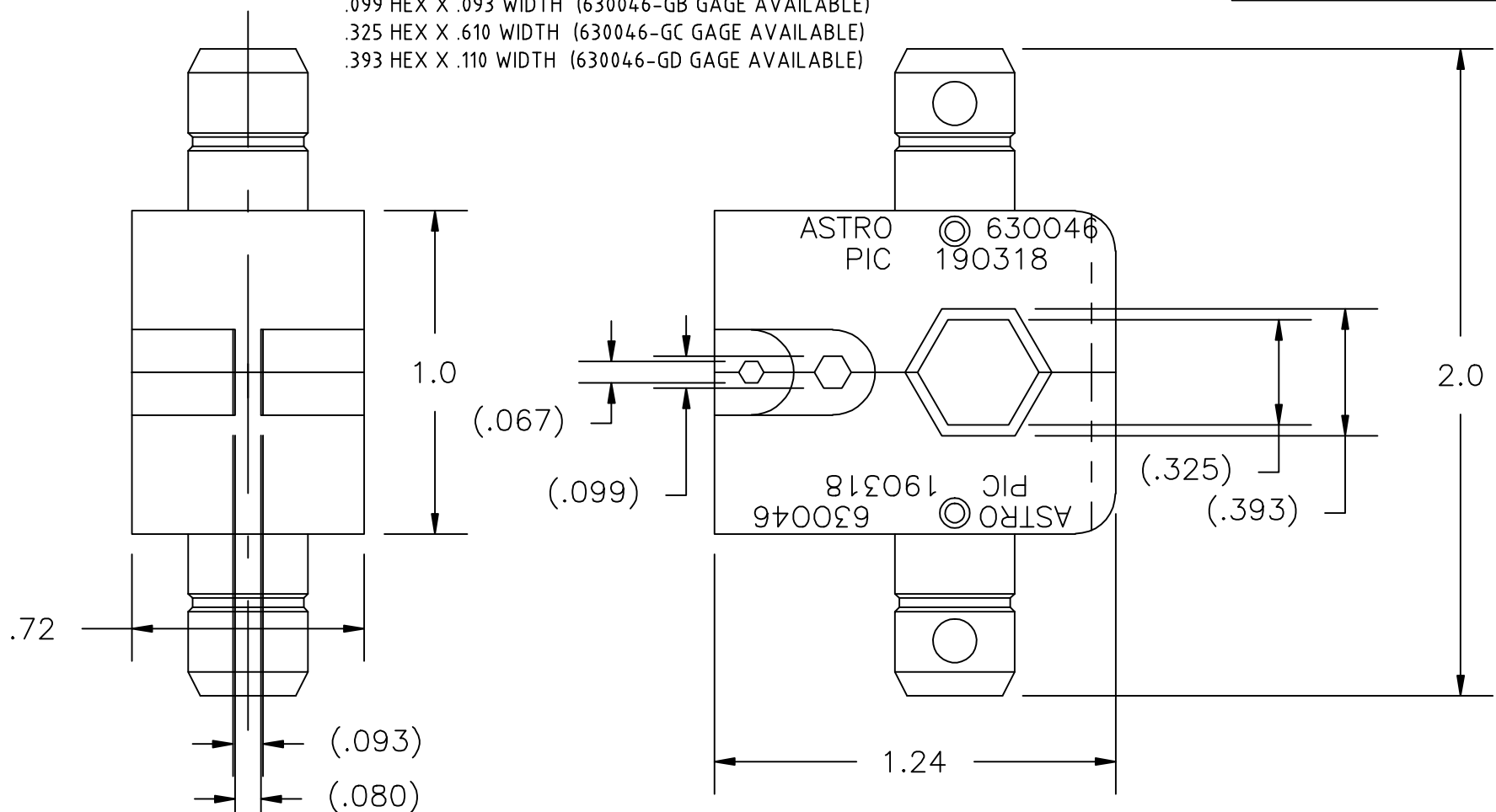

UNCONTROLLED DOCUMENT
WILL NOT BE UPDATED

NOTES: 1. THIS IS AN AUTOCAD DRAWING DO NOT CHANGE MANUALLY.

					<p>THESE DRAWINGS, SPECIFICATIONS OR OTHER DATA ARE AND REMAIN, THE PROPERTY OF ASTRO TOOL CORP. AND MUST BE RETURNED UPON REQUEST. THEY CONTAIN INFORMATION OWNED AND/OR DEVELOPED BY ASTRO AT ITS OWN PRIVATE EXPENSE AND MAY NOT BE USED, DUPLICATED OR DISCLOSED TO OTHERS, IN WHOLE OR IN PART FOR DESIGN, MANUFACTURE OR PROCUREMENT WITHOUT THE WRITTEN PERMISSION OF ASTRO TOOL CORP. EACH AND EVERY TIME.</p>	<p>SCALE: N.T.S.</p> <p>DWN BY: DY0</p> <p>DATE: 06-26-09</p> <p>APPROVED:</p>	<p>UNLESS OTHERWISE SPECIFIED:</p> <p>DECIMALS:</p> <p>.XXX ± .005</p> <p>.XX ± .010</p> <p>.X ± .030</p> <p>ANGLES: ± 1°</p>	<p>CAGE 58164</p> <p>ASTRO TOOL CORP.</p> <p>21615 S.W. TUALATIN VALLEY HWY., BEAVERTON OR 97006</p>
A	NEW RELEASE.	DY0	06-26-09	MMK	<p>DESCRIPTION: ENVELOPE DRAWING: 630046 DIE SET</p>			
REV.	DESCRIPTION	BY	DATE	APR.	PART NO.	A	630046-ENV	