

DETAILS

Product Number	FC13978_ANGELINA-RZ-M-B
Family	ANGELINA
Type	RefPack
Color	metal
Diameter	82 mm
Height	31 mm
Style	round
Optic Material	PC
Holder Material	
Fastening	screw, socket
Status	production ready
ROHS Compliant	Yes
Date Updated	13/06/2014



OPTICAL PROPERTIES

LED	Viewing Angle	Light Beam	Efficiency	cd/lm	Connector
CLL03x/CLU03x	43 deg	Medium	89 %	1.050	A.A.G. STUCCHI: 8101/G2
CLL04x/CLU04x	50 deg	Medium	87 %	0.920	A.A.G. STUCCHI: 8102/G2
CXA/B 25xx	46 deg	Medium	89 %	0.990	BJB: 47.319.2141
LUXEON K12	48 deg	Medium	89 %	1.000	BJB: 47.319.2070
LUXEON K16	50 deg	Medium	89 %	1.000	BJB: 47.319.2070
LUXEON CoB 1216	50 deg	Medium	88 %	0.930	BJB: 47.319.2030
COB D Series LES 14.5 mm	45 deg	Medium	89 %	1.000	A.A.G. STUCCHI: 8101/G2
COB D Series LES 14.5 mm	45 deg	Medium	89 %	1.000	BJB: 47.319.2021
Tiger Zenigata (GWTGCBG4FD)	41 deg	Medium	90 %	1.100	BJB: 47.319.2051

D C B A

4

4

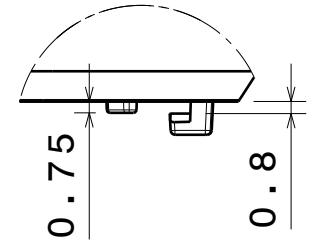
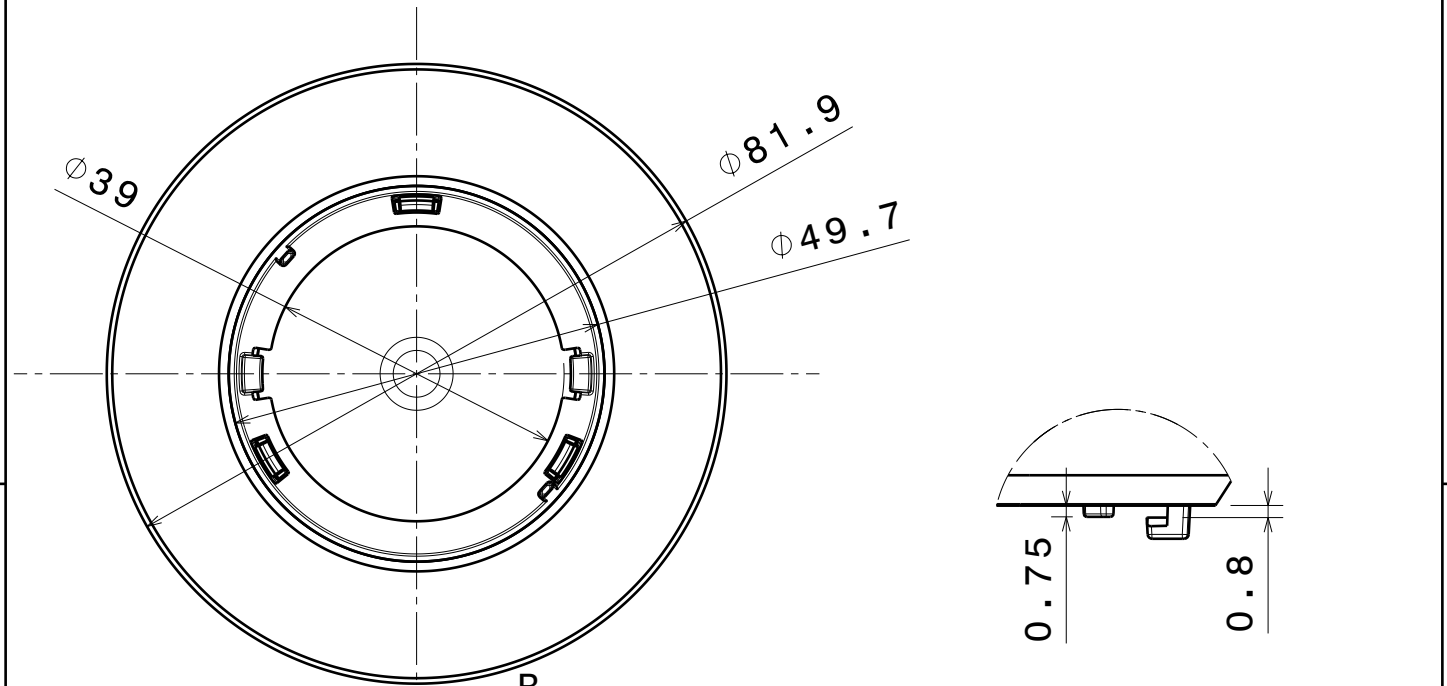

Detail A
Scale: 2:1

3

3

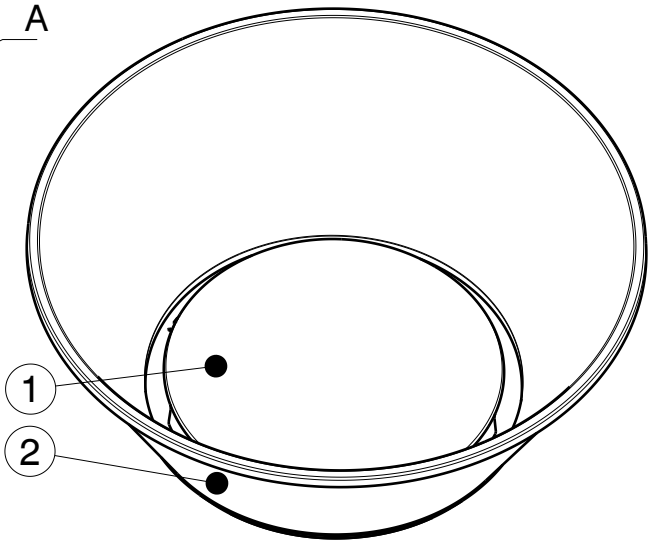
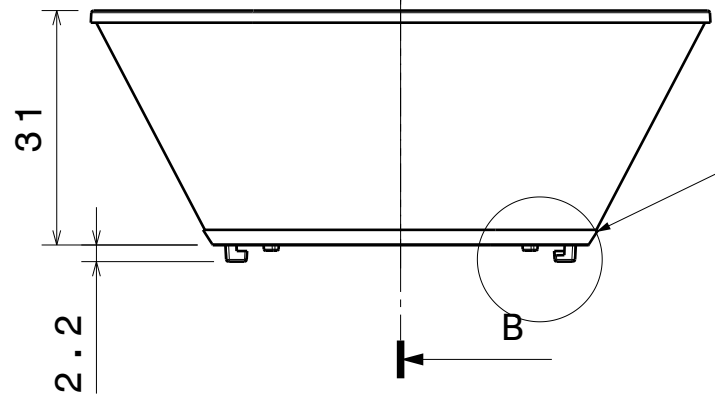

2

2

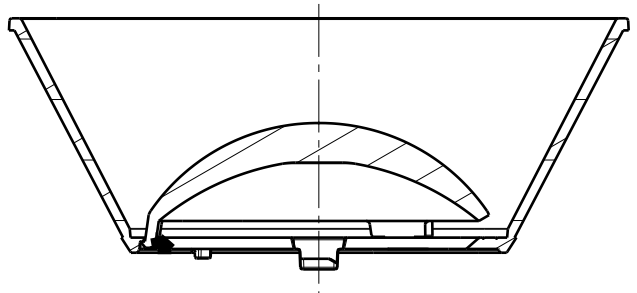

Section view B-B
Scale: 1:1

INDEX	PART NO	DESCRIPTION	MATERIAL	COLOUR
1		ANGE-RZ-lens	PC	
2		ANGELINA-B reflector	PC	metal

Tolerances if not otherwise shown
According to DIN ISO 2768-1
Linear measures:
Up to 30mm class M, otherwise class C.
According to DIN ISO 2768-2
Form and position: class L



Ledil Oy
Salorankatu 10
FIN 24240 SALO
Finland

THIRD ANGLE PROJECTION:

DRAWING TITLE
Angelina-B-RZ Assy

This drawing is the property of LEDiL Oy. It may not be reproduced, copied or communicated without a written agreement with LEDiL Oy."

SIZE PART NUMBER
A4

SCALE 1:1 WEIGHT 16,43 g SHEET 1/1

1

1

D A

Luminaire: LEDiL Oy FC13978_ANGELINA-RZ-M-B_(CLU034)_(Stucchi_8101/G2)
Lamps: 1 x Citizen_CLU034_(CLU034-1205B8-303M1A2)_+_ (Stucchi_8101/G2)_1150.05lm@250mA_P=8.45123W_I=0.250A

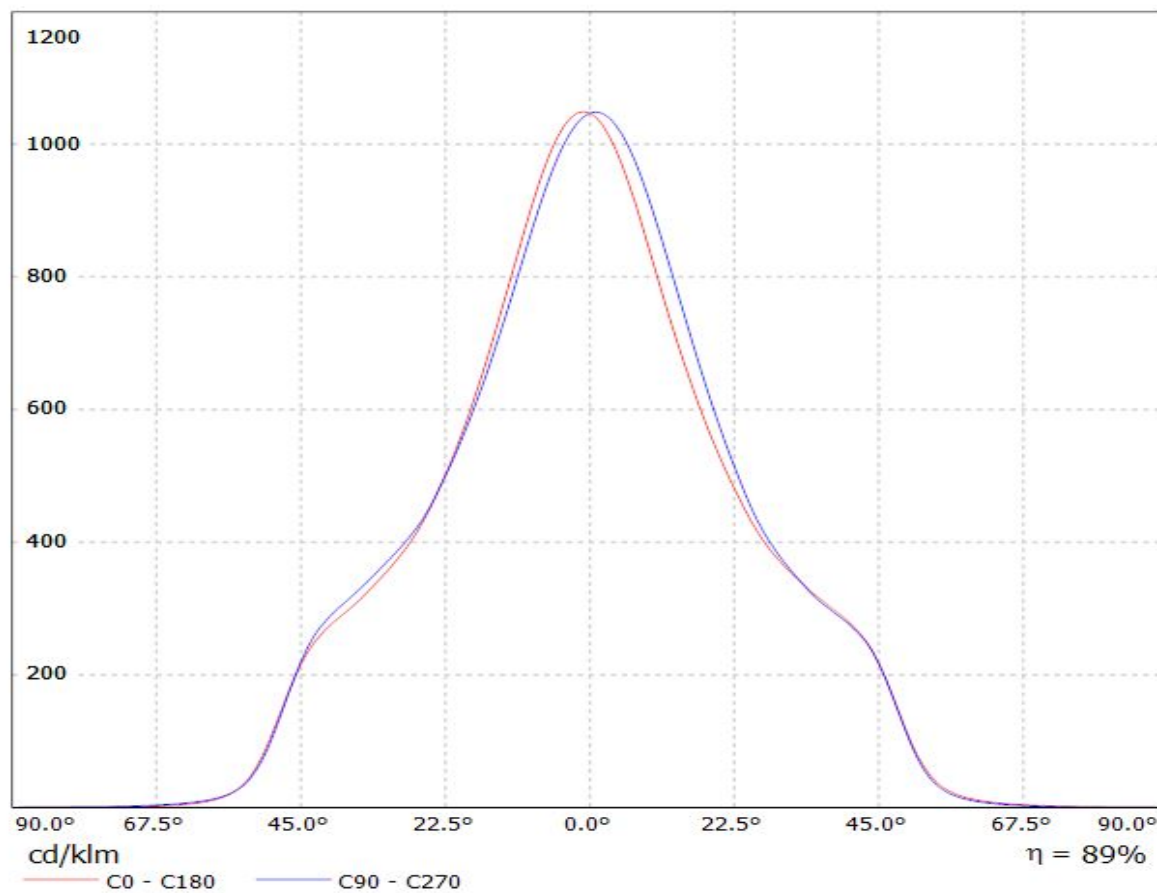

Luminaire: LEDiL Oy FC13978_ANGELINA-RZ-M-B_(CLU044)_+_ (Stucchi_8102-G2)
Lamps: 1 x Citizen_CLU044_(1212B8-303M1A2)_+_ (Stucchi_8102/G2)_1291.68lm@250mA_P=8.13748W_I=0.250A

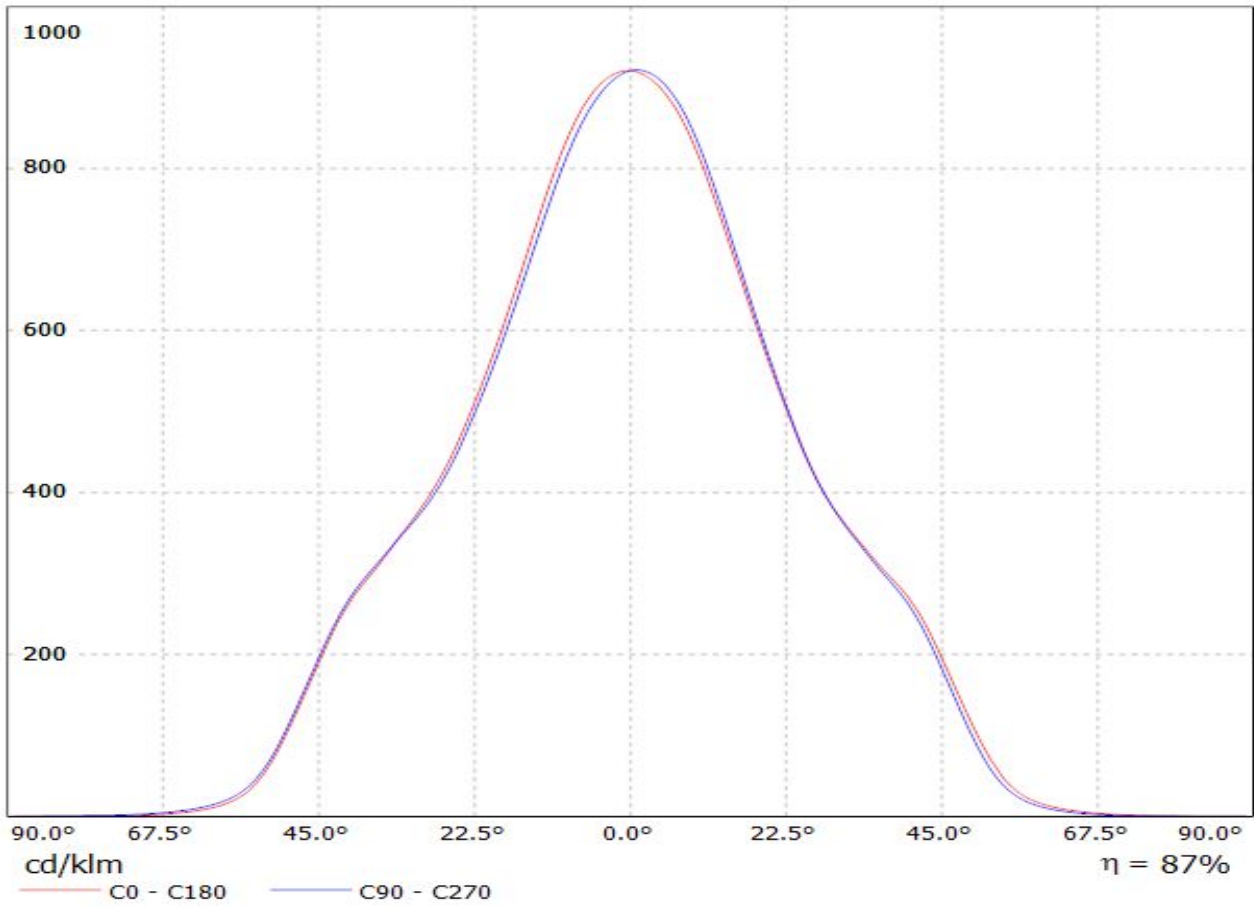

Luminaire: Ledil FC13978_ANGELINA-RZ-M-B_(CXB2540+_BJB_47.319.2140)
Lamps: 1 x CREE_CXB2540_(-40G-W4-N0H-00002)
+_BJB_47.319.2140_1412.99lm@250mA_CCT=40000K_P=8.1310W_I=0.25A

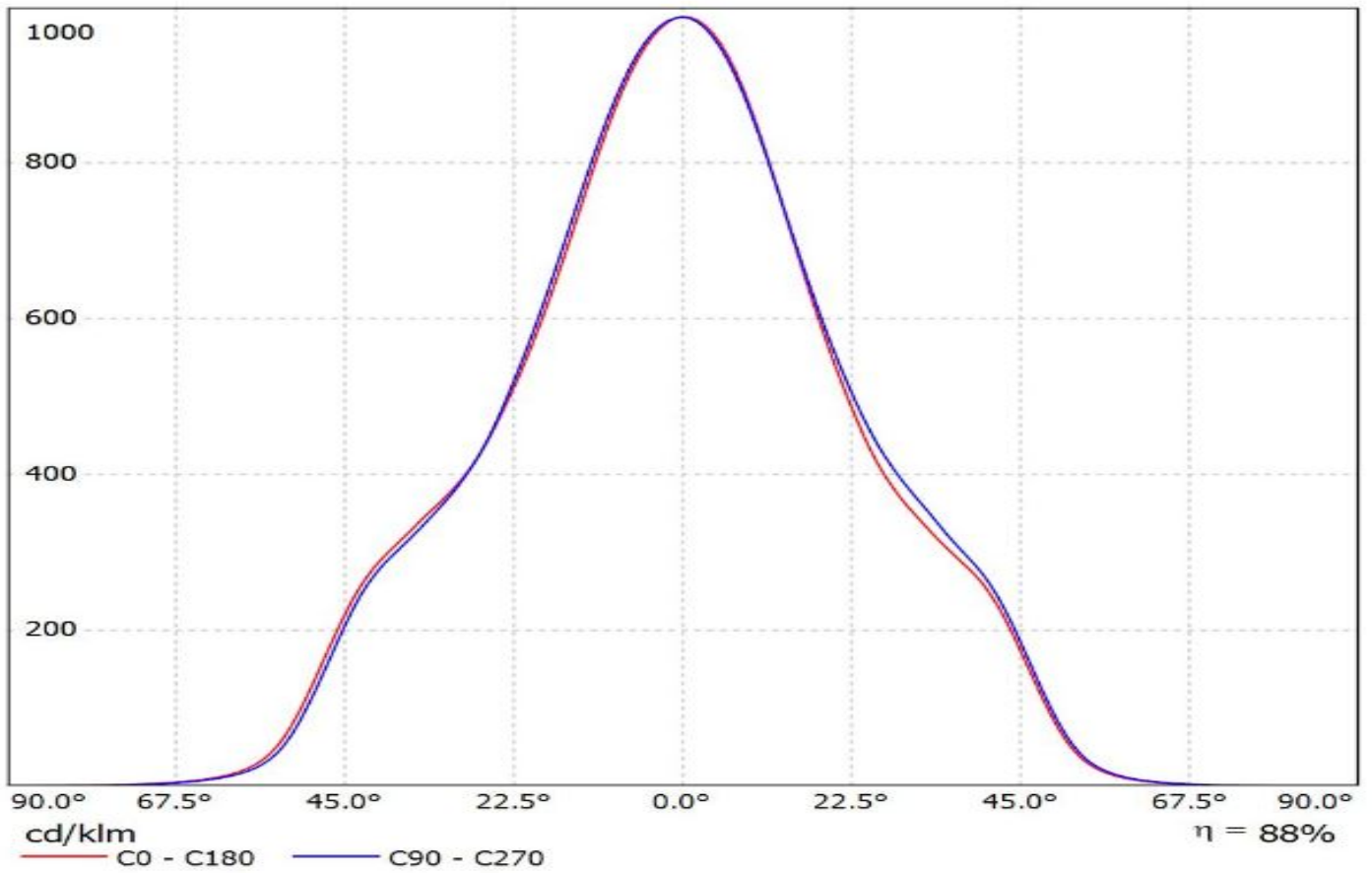

Luminaire: LEDil Oy FC13978_ANGELINA-RZ-M-B_(Luxeon_K12) Efficiency=89%
Lamps: 1 x Luxeon K12 (LXK8-PW40-0012) 930lm @ 250mA CCT=4000K P=8.2W I=250mA

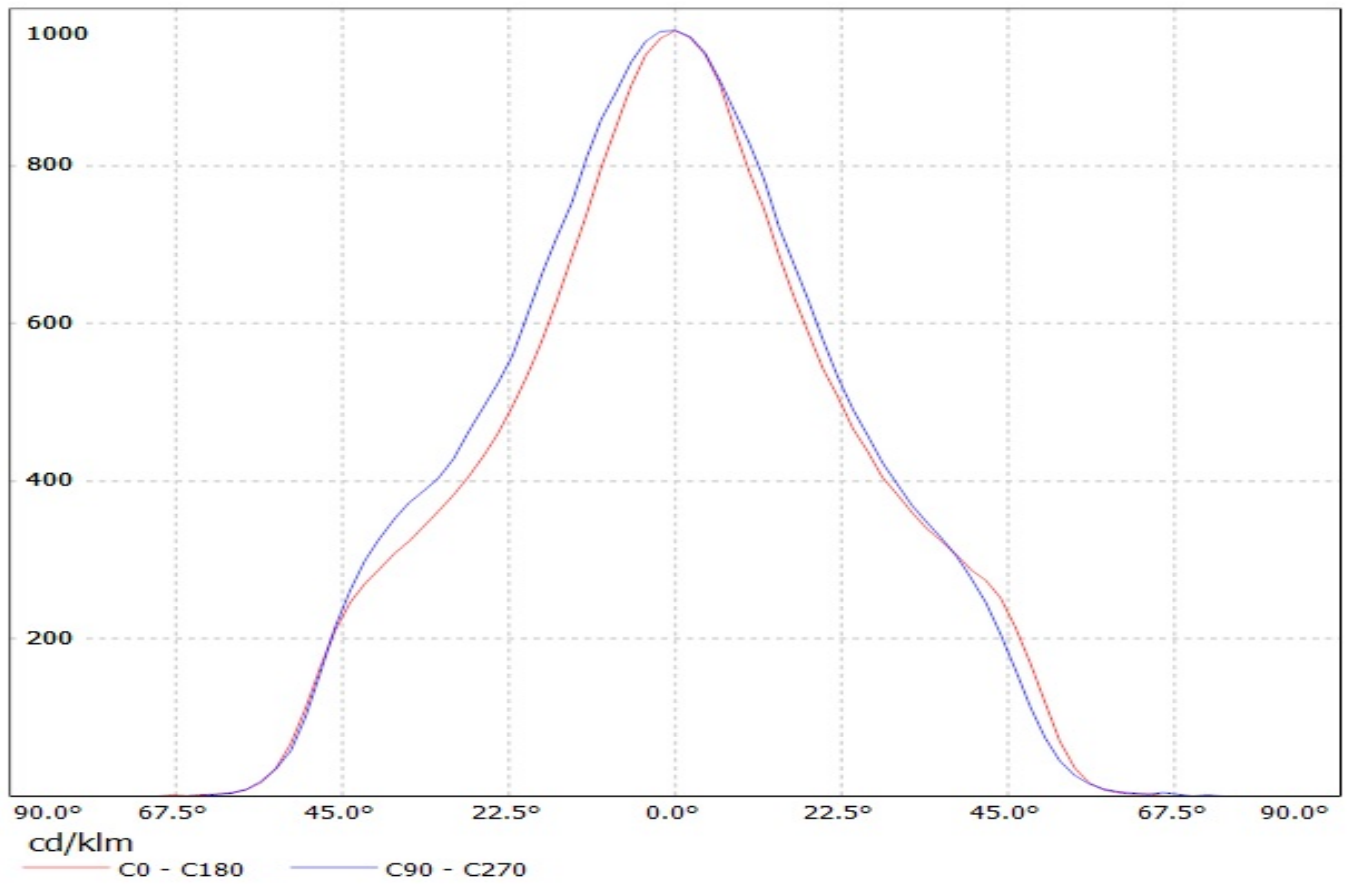

Luminaire: LEDil Oy FC13978_ANGELINA-RZ-M-B_(Luxeon_K16) Efficiency=89%
Lamps: 1 x Luxeon K16 (LXK8-PW40-0016) 1200lm @ 250mA CCT=4000 P=10.9W I=250mA

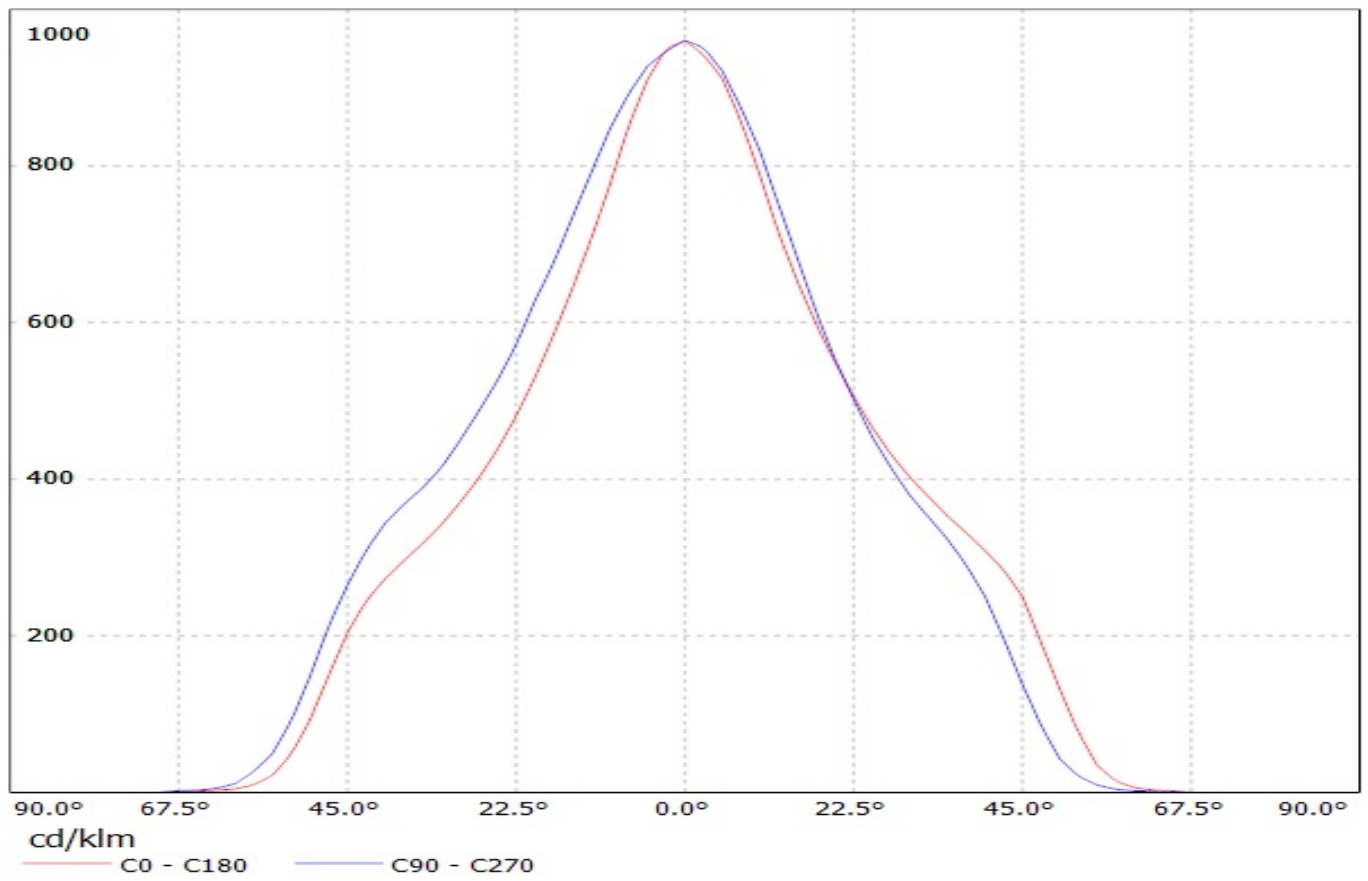

Luminaire: Ledil FC13978_ANGELINA-RZ-M-B_(CoB_1216)

Lamps: 1 x Luxeon_CoB_1216_(L2C2-40801216E2300)_1478.81lm@250mA_P=8.0033W_I=0.25A

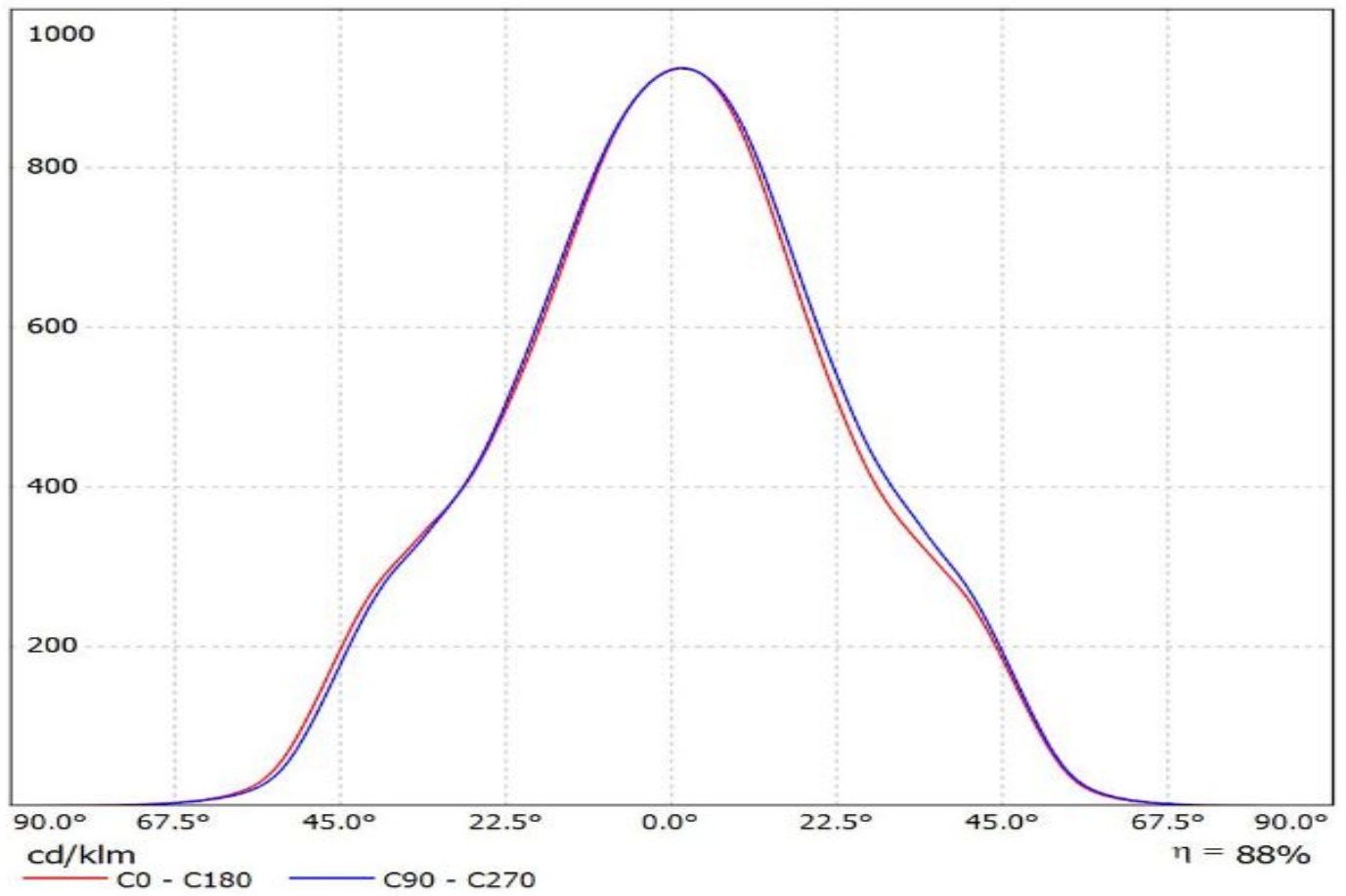

Luminaire: LEDiL Oy FC13978_ANGELINA-RZ-M-B_(COB_D_14,5mm)

Lamps: 1 x Samsung_COB_D_Series-LES-14,5_LC026D_1296.34lm@250mA_CCT=3000K_P=8.1225W_I=0.250A

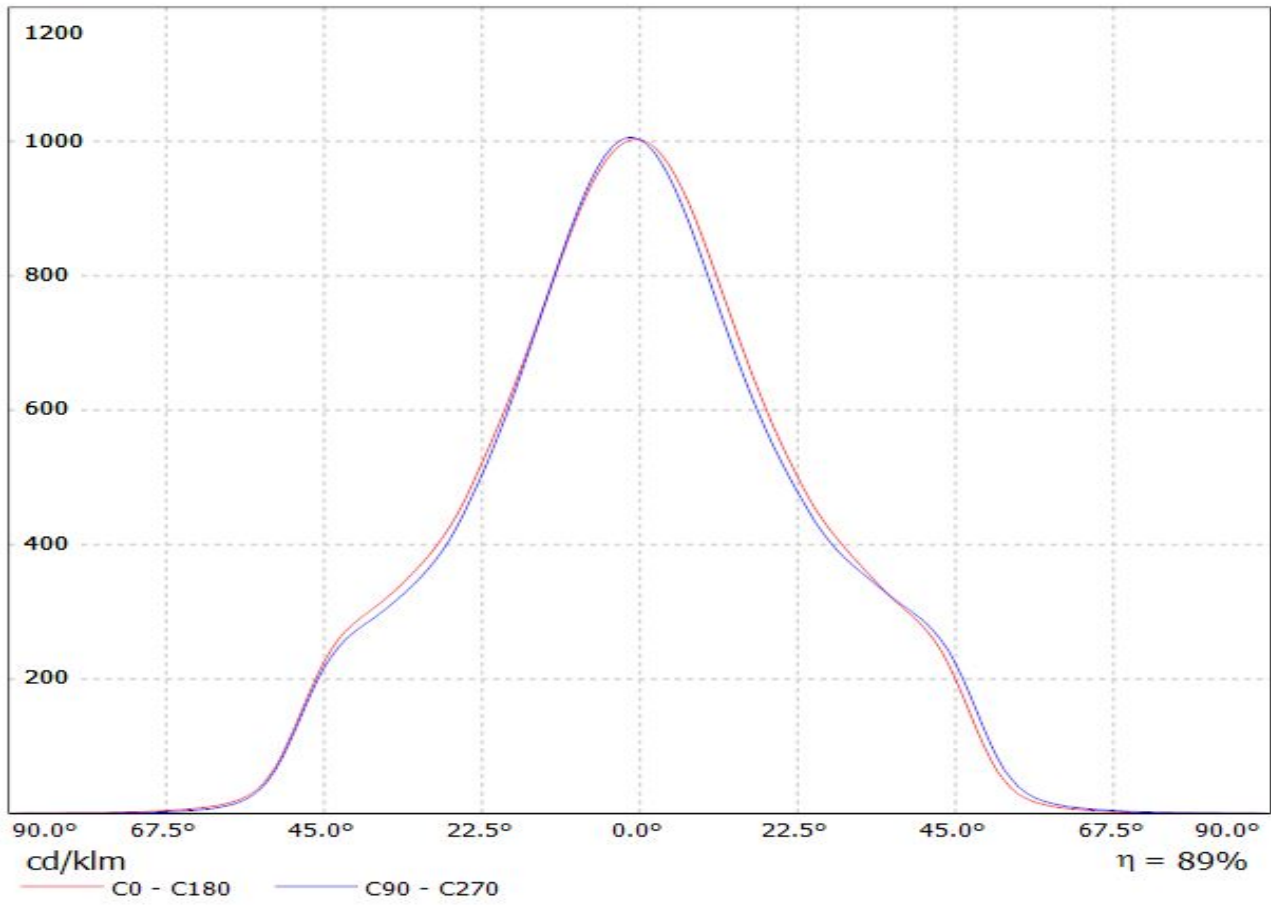

Luminaire: LEDiL Oy FC13978_ANGELINA-RZ-M-B_(COB_D_14,5mm)

Lamps: 1 x Samsung_COB_D_Series-LES-14,5_LC026D_1296.34lm@250mA_CCT=3000K_P=8.1225W_I=0.250A

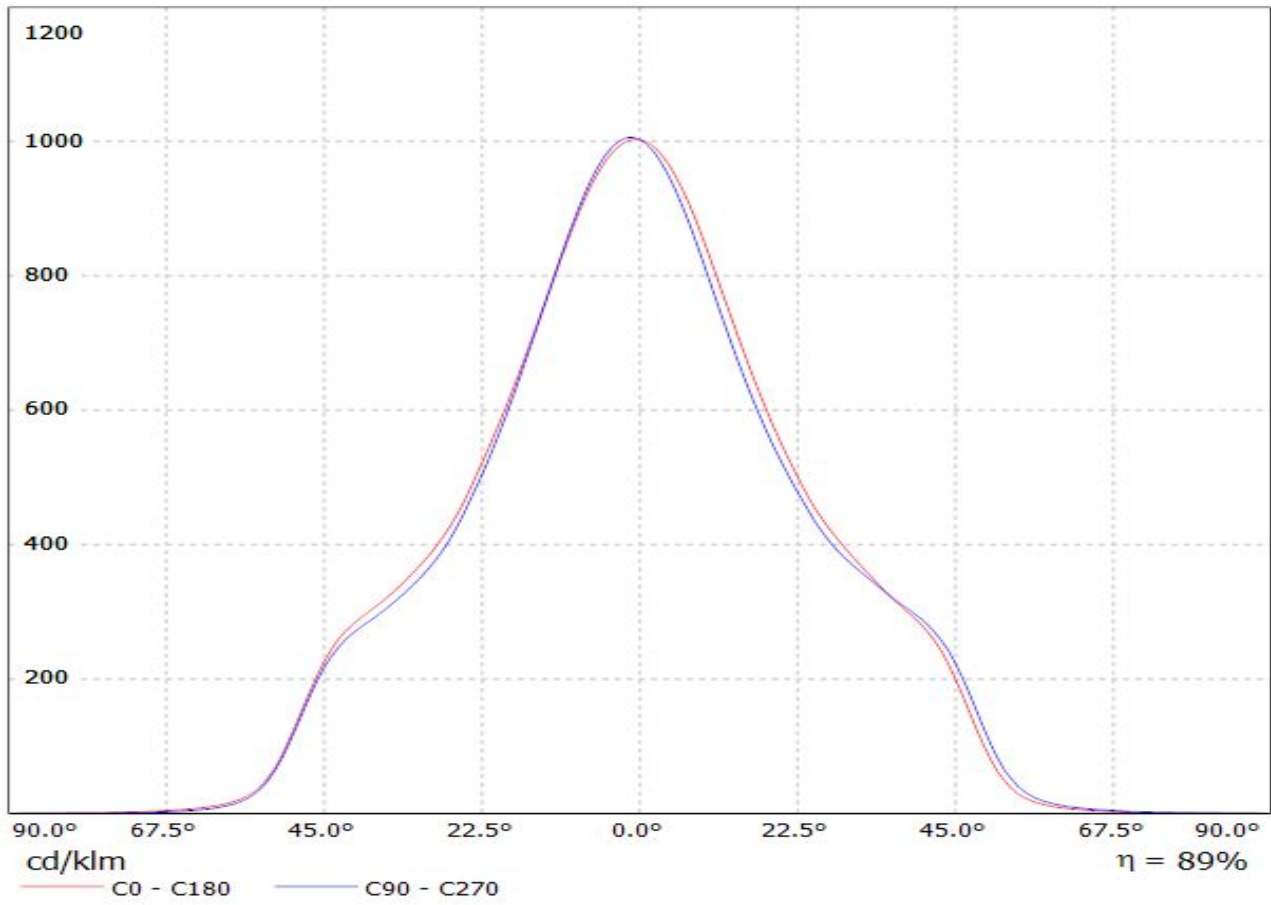

Luminaire: LEDiL Oy FC13978_ANGELINA-RZ-M-B_(Tiger) Eff. 90%
Lamps: 1 x SHARP TIGER_ZENIGATA_(GW6TGCBG4FD)_836.646lm@250mA_P=8.31759W_I=249.8mA

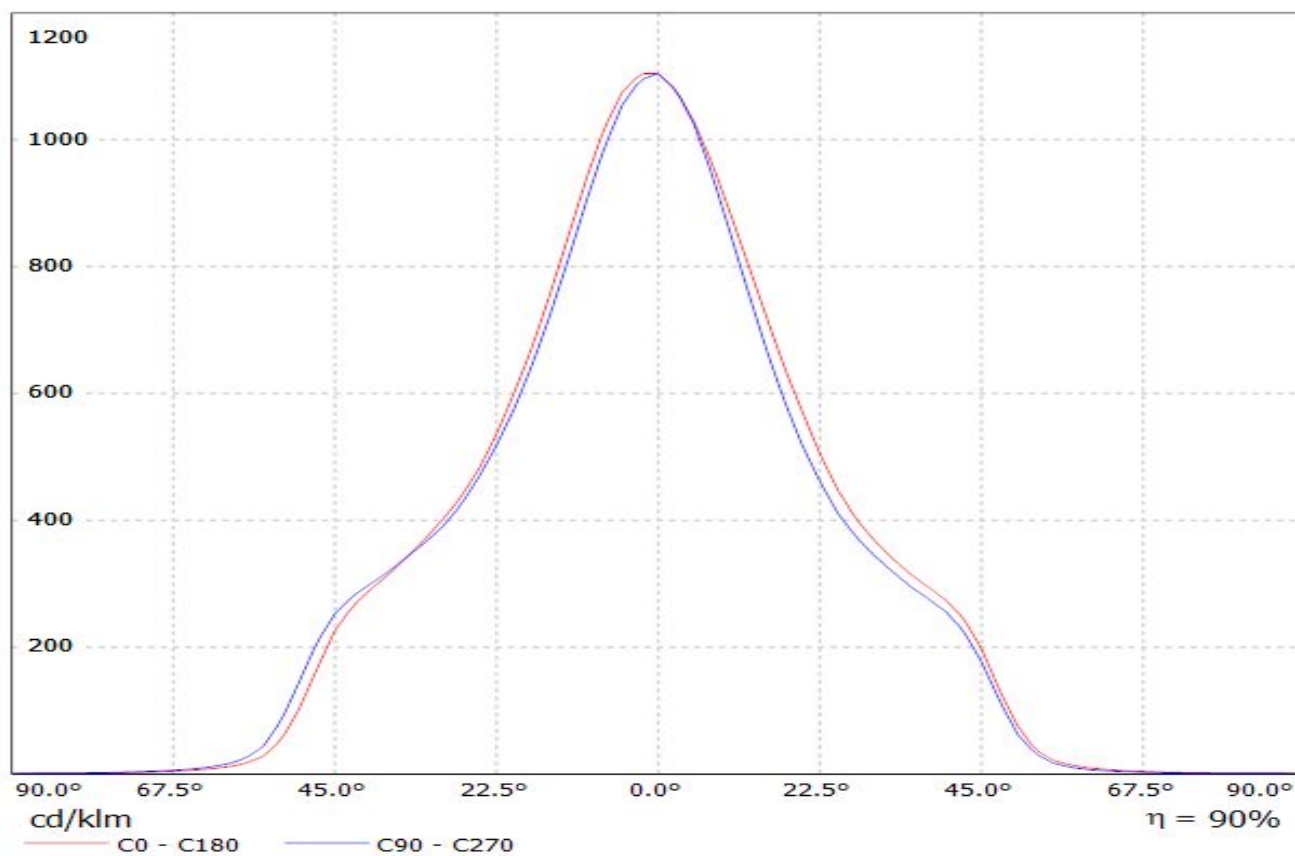

Luminaire: LEDiL Oy FC13978_ANGELINA-RZ-M-B_(CLU034)_(Stucchi_8101/G2)

Lamps: 1 x Citizen_CLU034_(CLU034-1205B8-303M1A2)_+(Stucchi_8101/G2)_1150.05lm@250mA_P=8.45123W_I=0.250A

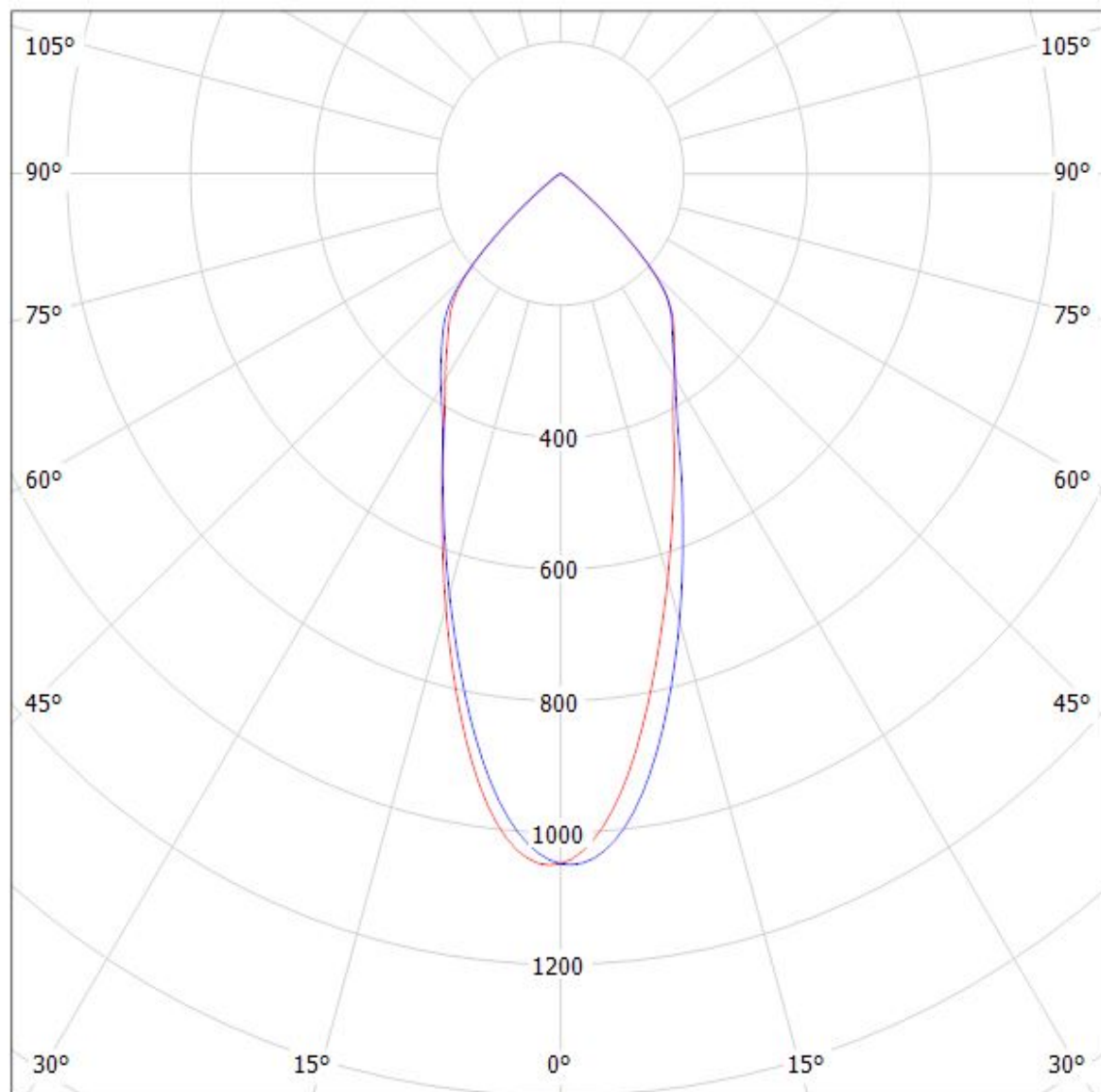

cd/klm

$\eta = 89\%$

— C0 - C180 — C90 - C270

Luminaire: LEDiL Oy FC13978_ANGELINA-RZ-M-B_(CLU044)_+_ (Stucchi_8102-G2)

Lamps: 1 x Citizen_CLU044_(1212B8-303M1A2)_+_ (Stucchi_8102/G2)_1291.68lm@250mA_P=8.13748W_I=0.250A

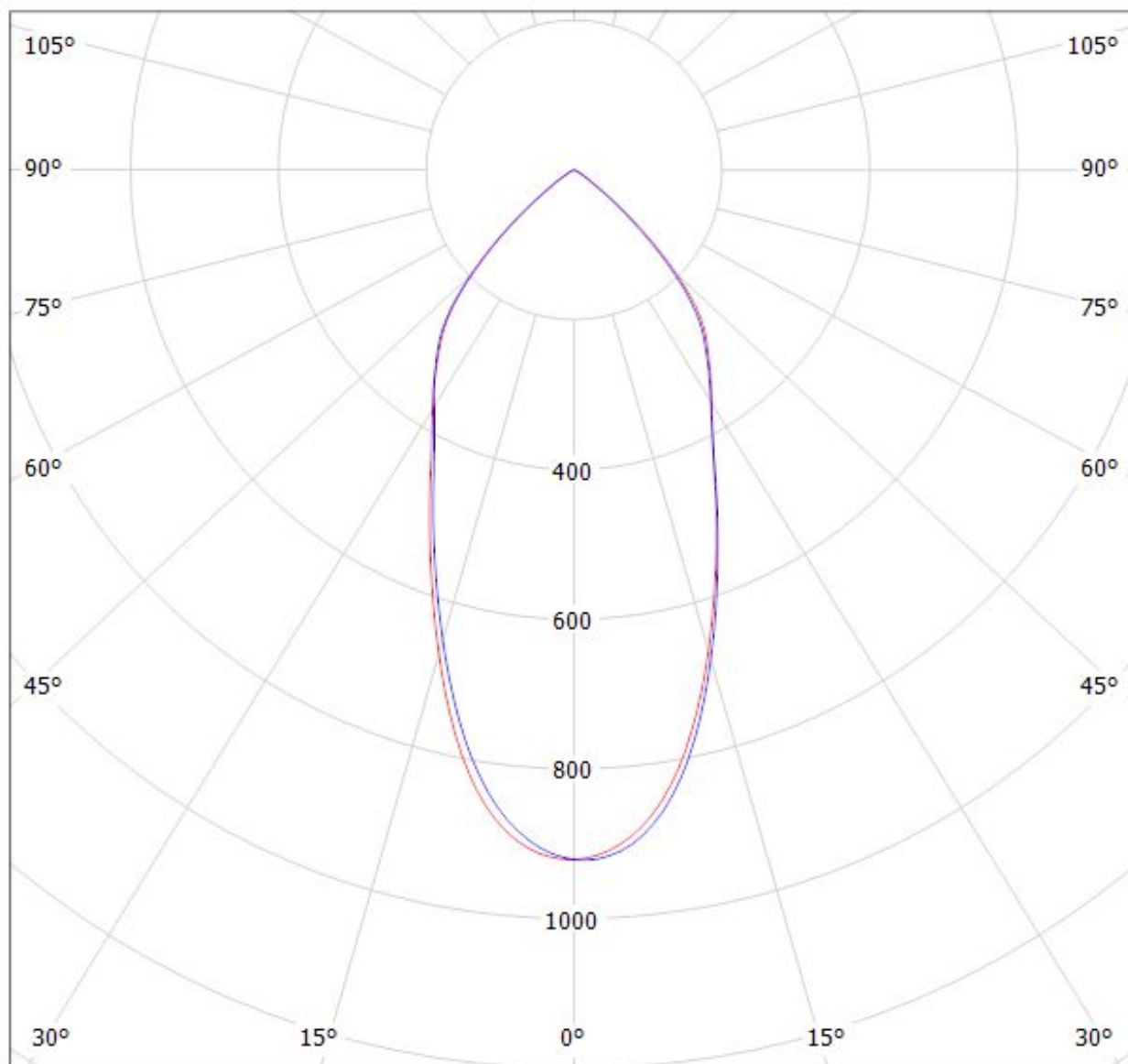

cd/klm

$\eta = 87\%$

— C0 - C180

— C90 - C270

Luminaire: Ledil FC13978_ANGELINA-RZ-M-B_(CXB2540+_BJB_47.319.2140)
Lamps: 1 x CREE_CXB2540_(-40G-W4-N0H-00002)
+_BJB_47.319.2140_1412.99lm@250mA_CCT=40000K_P=8.1310W_I=0.25A

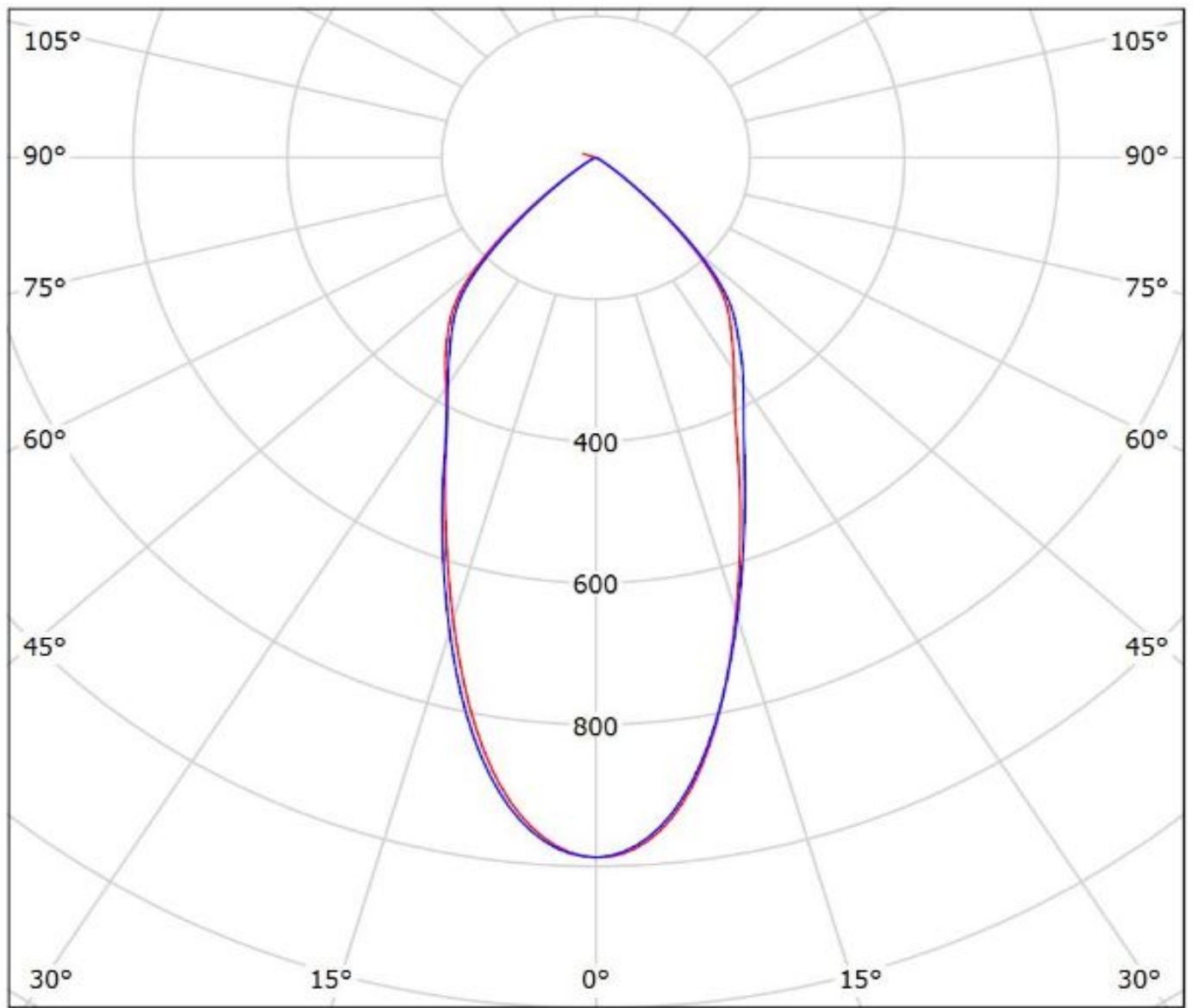

cd/klm

— C0 - C180 — C90 - C270

$\eta = 88\%$

Luminaire: LEDil Oy FC13978_ANGELINA-RZ-M-B_(Luxeon_K12) Efficiency=89%
Lamps: 1 x Luxeon K12 (LXK8-PW40-0012) 930lm @ 250mA CCT=4000K P=8.2W I=250mA

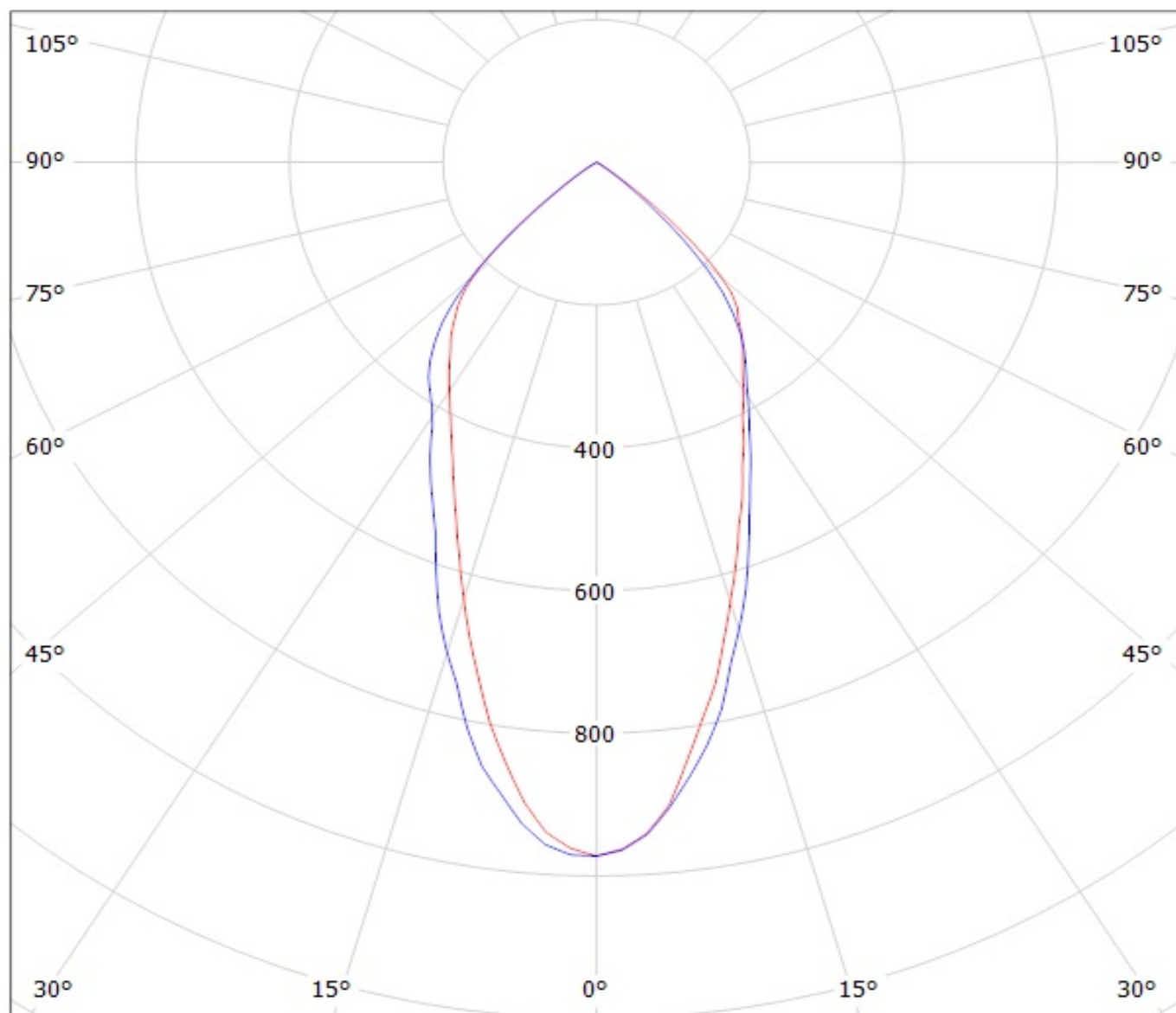

cd/klm

— C0 - C180

— C90 - C270

Luminaire: LEDil Oy FC13978_ANGELINA-RZ-M-B_(Luxeon_K16) Efficiency=89%
Lamps: 1 x Luxeon K16 (LXK8-PW40-0016) 1200lm @ 250mA CCT=4000 P=10.9W I=250mA

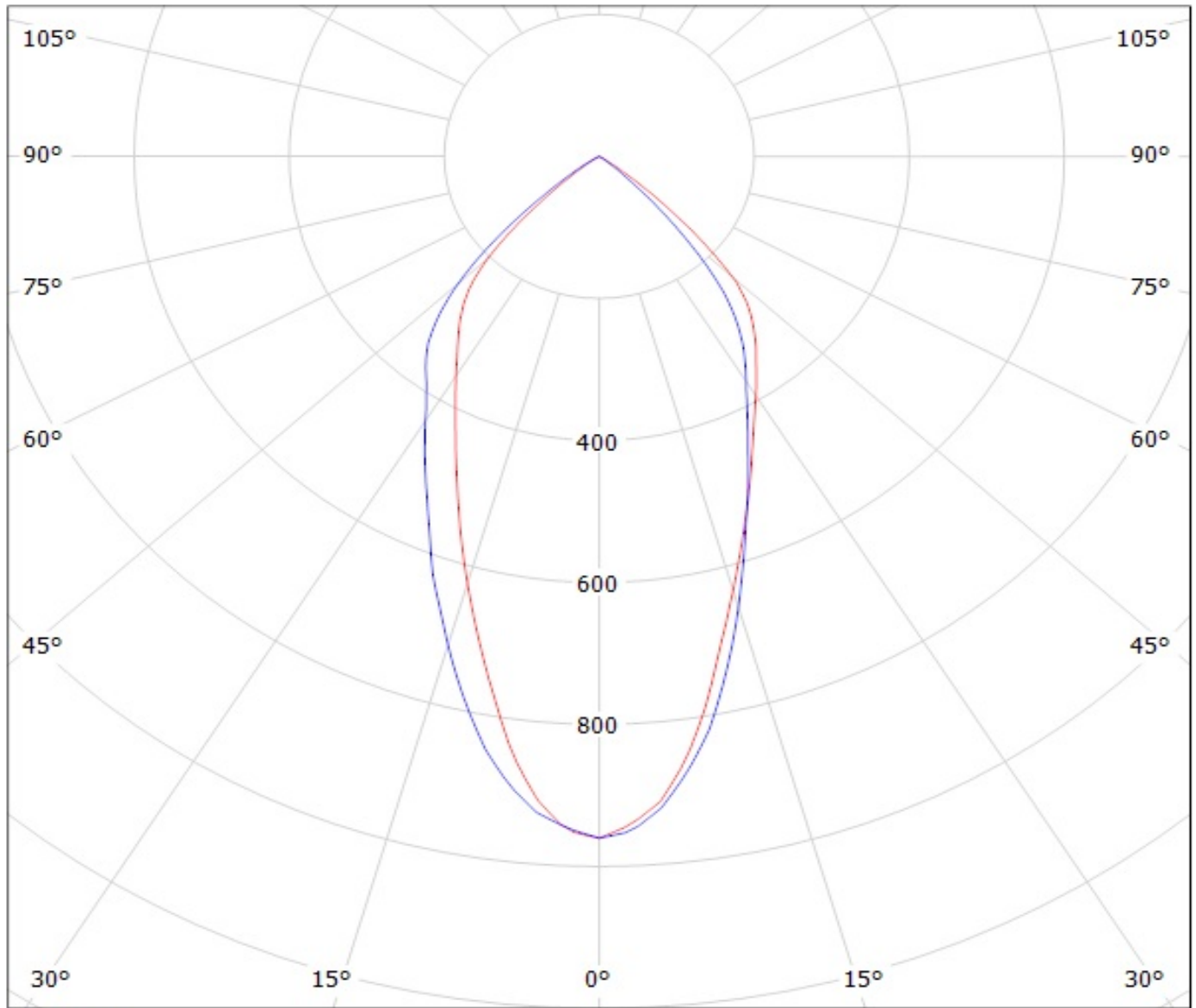

cd/klm

— C0 - C180

— C90 - C270

Luminaire: Ledil FC13978_ANGELINA-RZ-M-B_(CoB_1216)

Lamps: 1 x Luxeon_CoB_1216_(L2C2-40801216E2300)_1478.81lm@250mA_P=8.0033W_I=0.25A

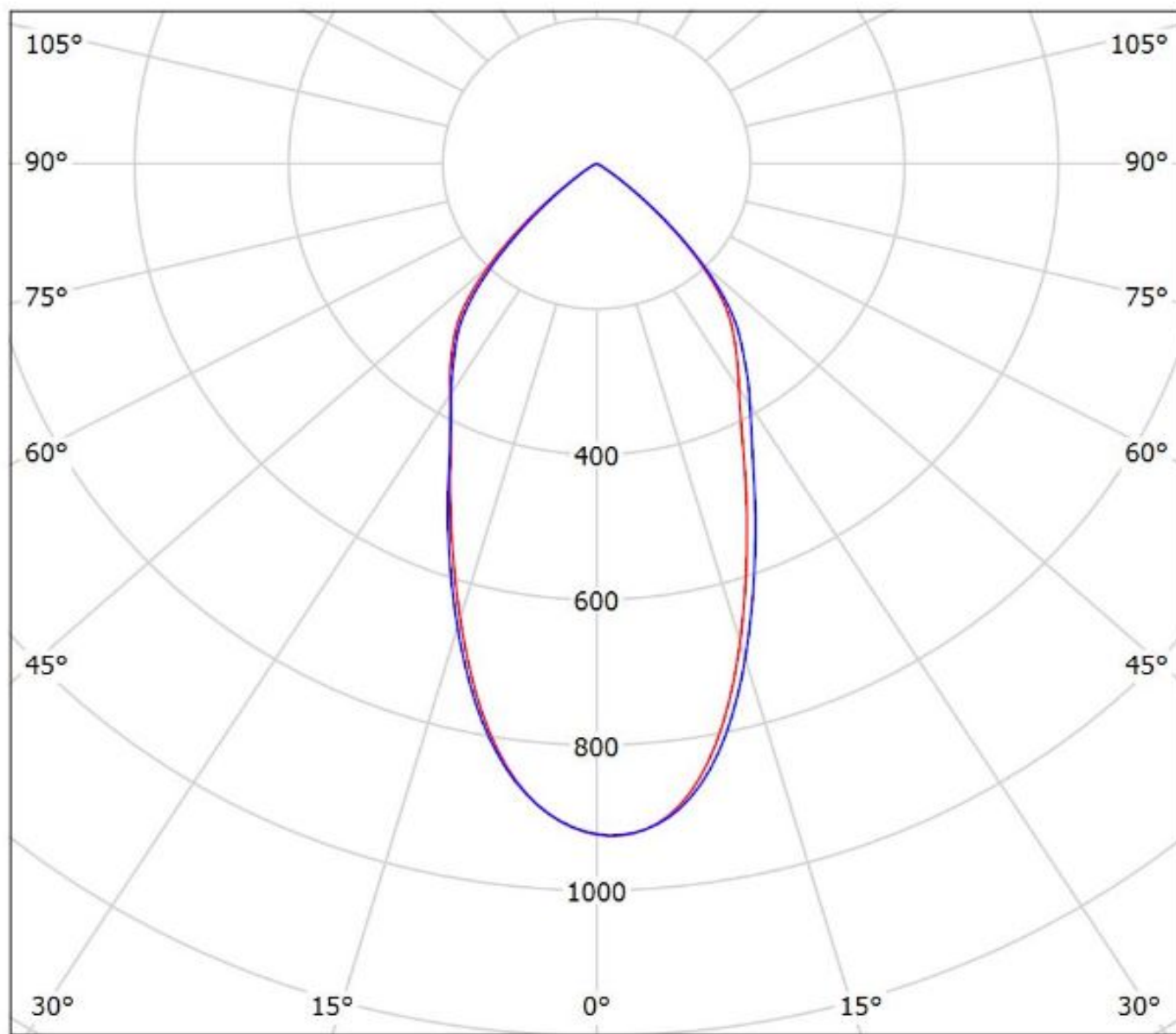

cd/klm

— C0 - C180 — C90 - C270

$\eta = 88\%$

Luminaire: LEDiL Oy FC13978_ANGELINA-RZ-M-B_(COB_D_14,5mm)

Lamps: 1 x Samsung_COB_D_Series-LES-14,5_LC026D_1296.34lm@250mA_CCT=3000K_P=8.1225W_I=0.250A

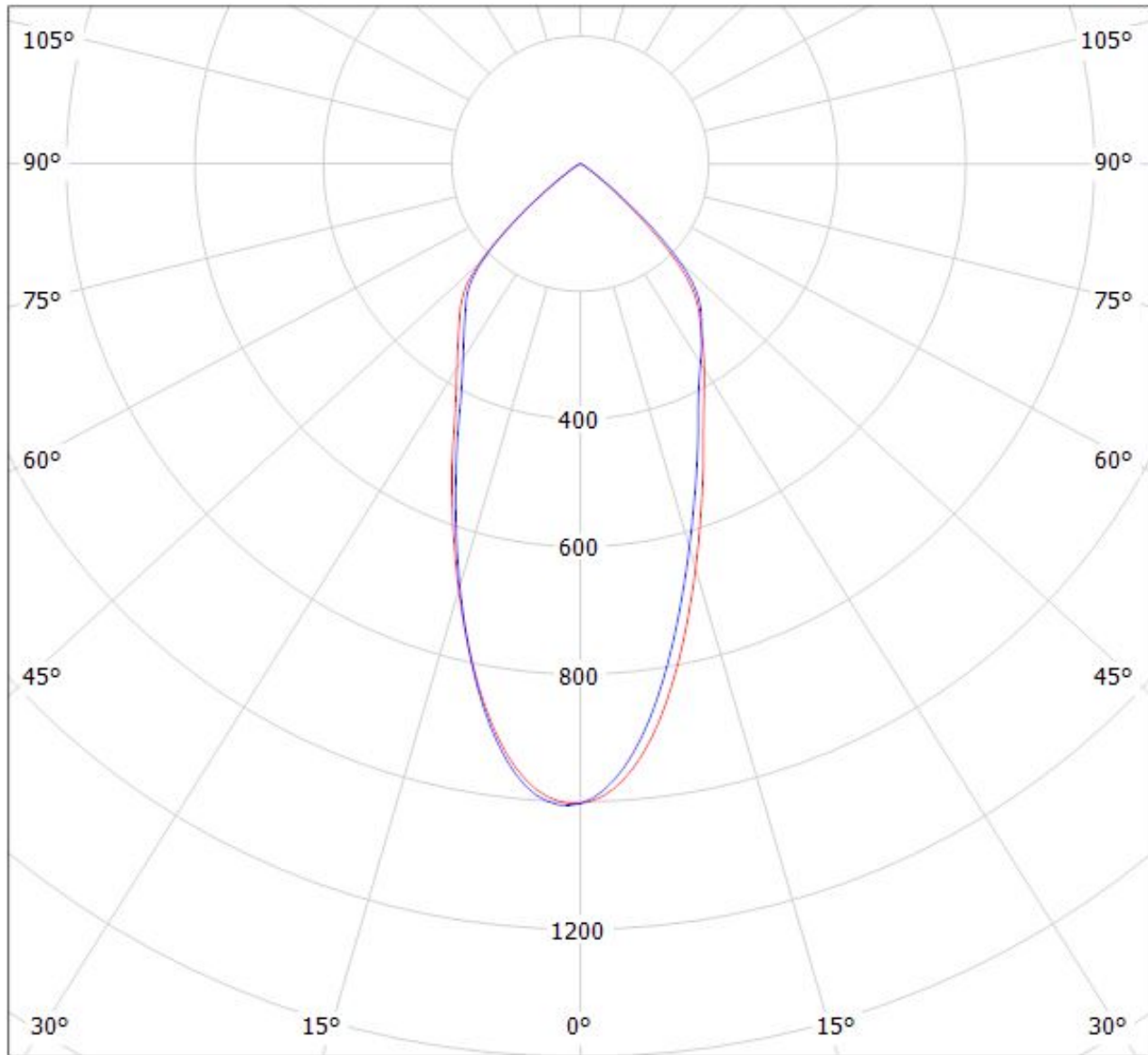

cd/klm

— C0 - C180 — C90 - C270

$\eta = 89\%$

Luminaire: LEDiL Oy FC13978_ANGELINA-RZ-M-B_(COB_D_14,5mm)

Lamps: 1 x Samsung_COB_D_Series-LES-14,5_LC026D_1296.34lm@250mA_CCT=3000K_P=8.1225W_I=0.250A

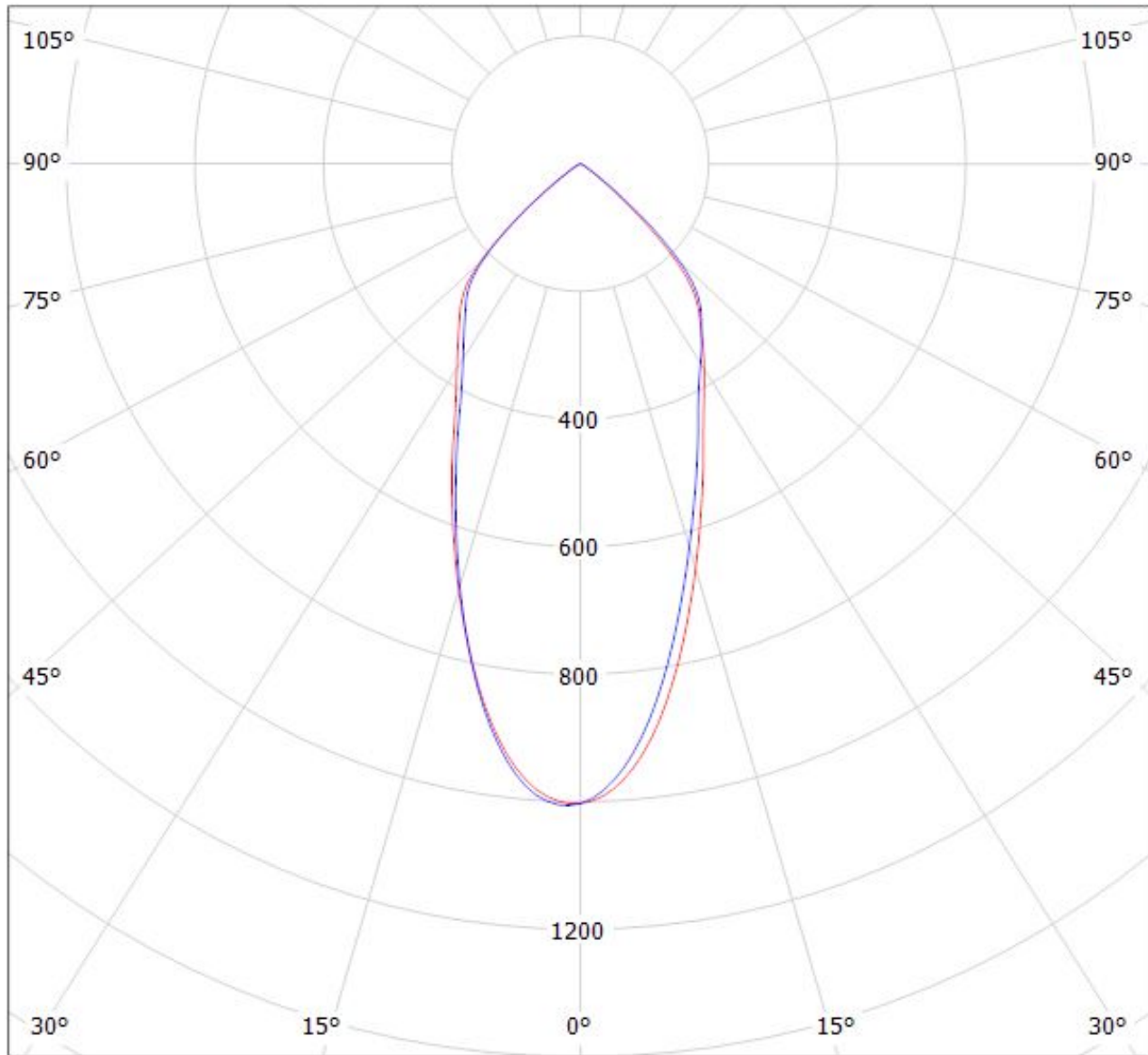

cd/klm

— C0 - C180 — C90 - C270

$\eta = 89\%$

Luminaire: LEDiL Oy FC13978_ANGELINA-RZ-M-B_(Tiger) Eff. 90%

Lamps: 1 x SHARP TIGER_ZENIGATA_(GW6TGCBG4FD)_836.646lm@250mA_P=8.31759W_I=249.8mA

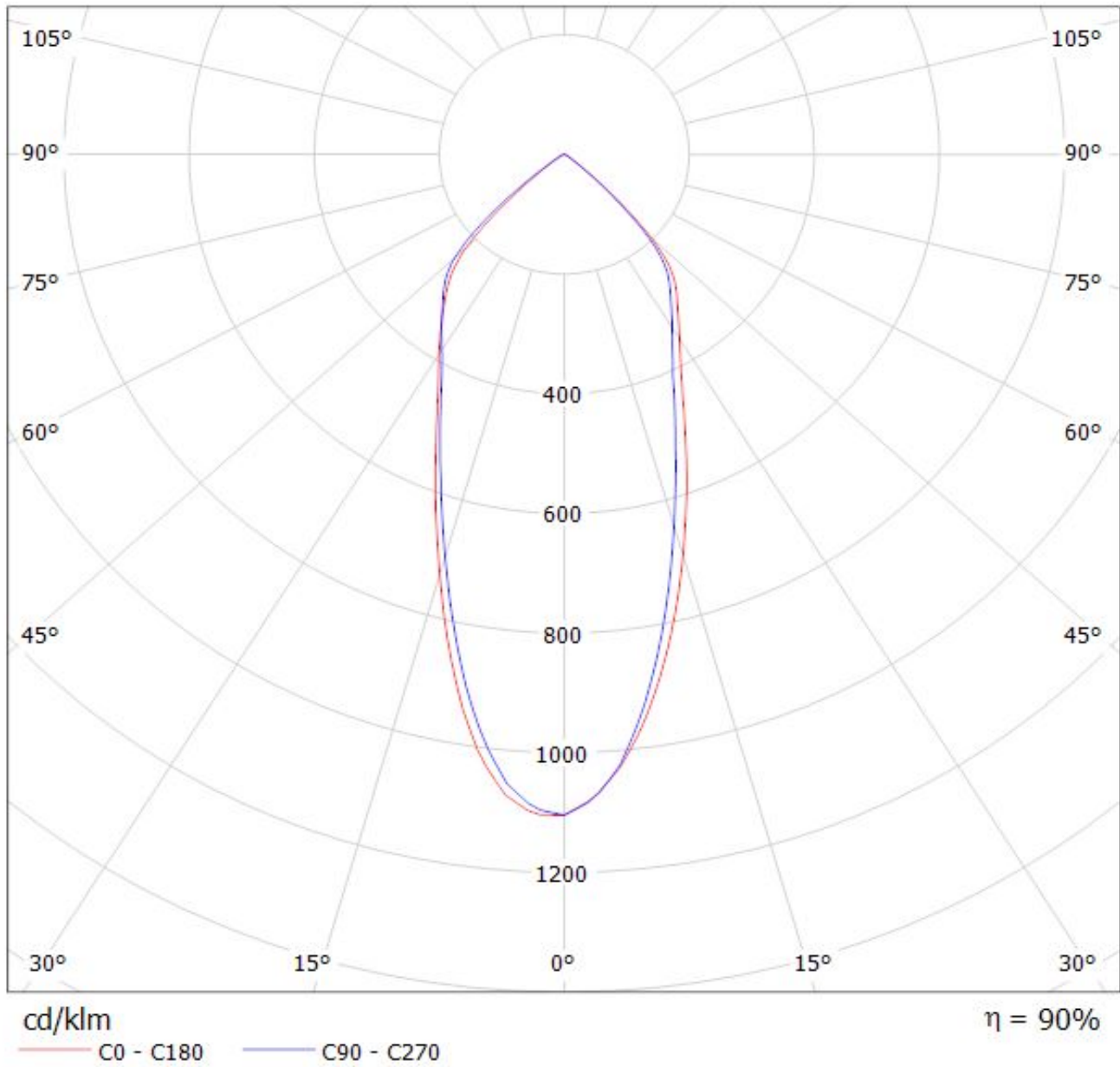

NOTE: The typical divergence will be changed by different color, chip size and chip position tolerance. The typical total divergence is the full angle measured where the luminous intensity is half of the peak value.

GENERAL INFORMATION

- Product series especially designed & optimized for series of LEDs.
- Special care taken to make light distribution as uniform as possible.

Note! Due to use of high power COB's with this product, special attention to proper thermal design is highly recommended. LEDiL has no liability for direct, indirect or consecutive damages arising from the LEDiL products being used outside of the recommended temperature range.