

Programming Quick Guide

DFR0314 Barcode Reader

Factory Default Settings

| Function | Default |
|------------------------------|---|
| Interface | Keyboard Mode |
| Reading Mode | GoodReadOFF |
| RS232 BAUD Rate | 9600 |
| Data Bits | 8 Data Bits |
| Stop Bits | 1 Bit |
| Handshaking | RTS/CTS Disable |
| Keyboard Wedge Mode | IBM PC/AT, PS/2 |
| Output Characters Terminator | CR+LF |
| Time-out Between Characters | 0 ms |
| Symbologies | UPC-A UPC-E EAN-13/JAN-13 EAN-8/JAN-8 CODE 39 CODE 128 CODABAR/NW7 Interleave 25 |
| Language | US English |
| Bar Code ID | OFF |
| Reading Level | Bar Equals Low |
| Accuracy | 1 Time |
| Buzzer Beep Tone | High |
| Sensitivity of Continuous | Fast |
| Notebook Function | Disable |
| Reverse Output Characters | Disable |

Symbologies Selection

UPC-A <ON>



%0A44

UPC-E <ON>



%0B08

EAN-13/JAN-13/ISBN-13 <ON>



%0A22

EAN-8/JAN-8 <ON>



%0A11

CODE 39 <ON>



%0E08

CODE 128 <ON>



%0F08

CODABAR/NW7 <ON>



%0J08

Interleaved 2 of 5 <ON>



%0G08

UPC-A OFF



%0A40

UPC-E OFF



%0B00

EAN-13/JAN-13/ISBN-13 OFF



%0A20

EAN-8/JAN-8 OFF



%0A10

CODE 39 OFF



%0E00

CODE 128 OFF



%0F00

CODABAR/NW7 OFF



%0J00

Interleaved 2 of 5 OFF



%0G00

CODE 93 ON



%0K08

China Postage ON



%0M08

Telepen ON



%0T08

GS1 DataBar Omnidirectional ON



%0U08

GS1 DataBar Limited ON



%0V08

GS1 DataBar Expanded ON



%0W08

Select All Bar Codes



%1A/ +

CODE 93 <OFF>



%0K00

China Postage <OFF>



%0M00

Telepen <OFF>



%0T00

GS1 DataBar Omnidirectional <OFF>



%0U00

GS1 DataBar Limited <OFF>



%0V00

GS1 DataBar Expanded <OFF>



%0W00

Set All Defaults



%\$+/ 2

Version Information



%\$+/ 5

Configuration Flow Chart

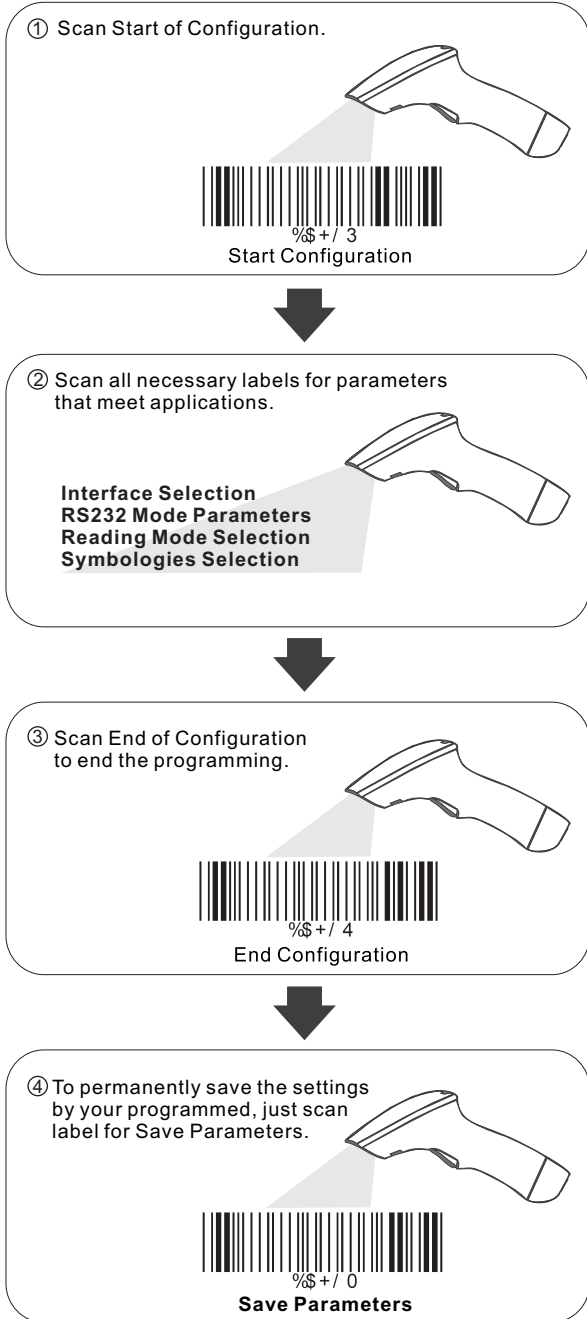

Interface Selection

<Keyboard Mode>

USB Mode

RS232 Mode

Reading Mode Selection

<Good Read OFF>

Continuous/Trigger OFF

Continuous/Auto Power On

Flash/Auto Power On

Trigger ON/OFF

Testing

Flash

Auto Sense (Option)

Select Terminator

<CR+LF>

CR

Space

STX-ETX

None

LF

HT(TAB)

RS232 Mode Parameters

A> Set Up BAUD Rate
1200

2400

4800

19200

B> Set Up Data Bits
7 Data Bits

<8 Data Bits>

2 Bits

D> Set Up Parity
<None>

Odd

Space

E> Handshaking
RTS/CTS Enable

<RTS/CTS Disable>

ACK/NAK Enable

<ACK/NAK Disable>

XON/XOFF Enable

<XON/XOFF Disable>